

1 Fold bottom flaps in first.

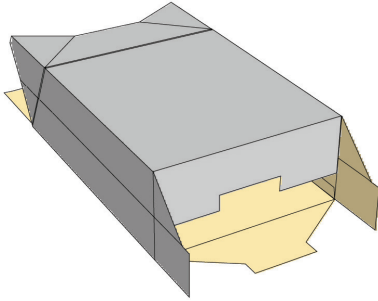

2

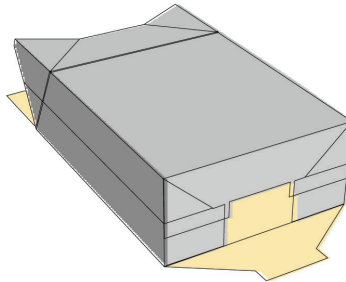

3

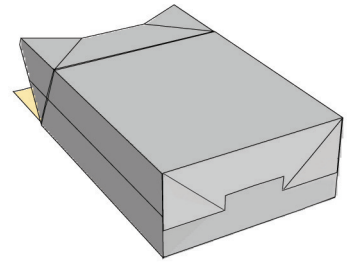

4 Stand base upright.

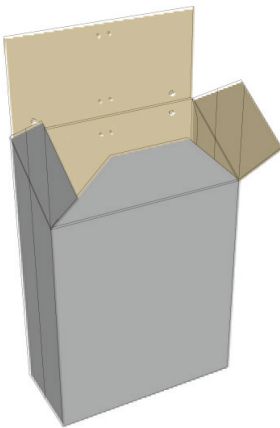

5 Fold up bottom insert (brown), then place a piece of tape on the edge indicated to secure.

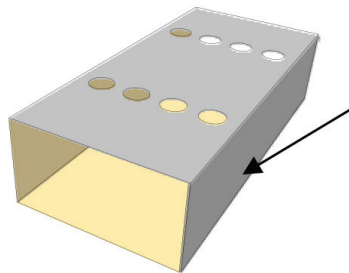

6 Place bottom insert into base first.

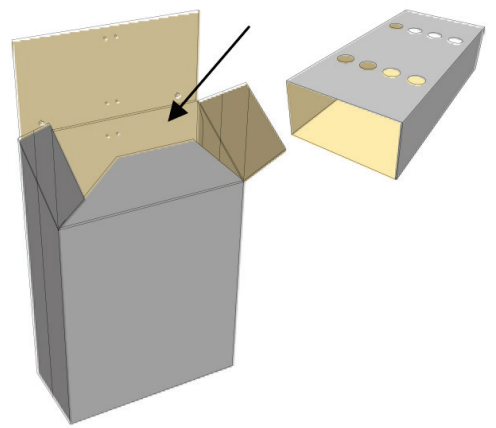

7 Fold up top insert.

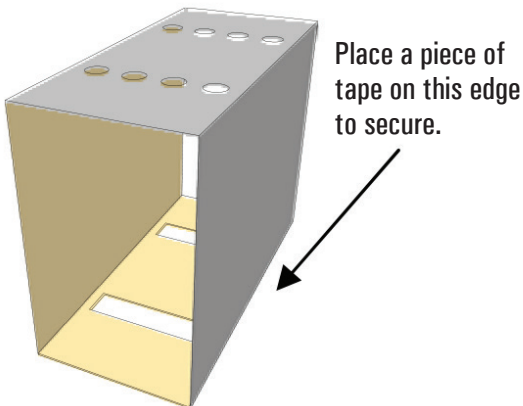

8 Fold flaps of base in, then place top insert in base.

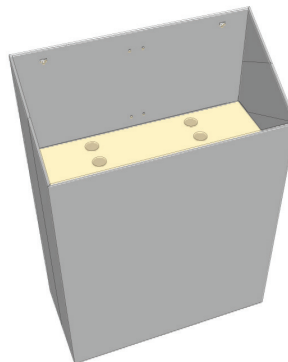

9 Use zip ties to secure pole to base.

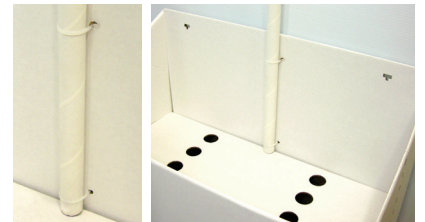

10 Place clip on top of pole, then place header poster into clip.

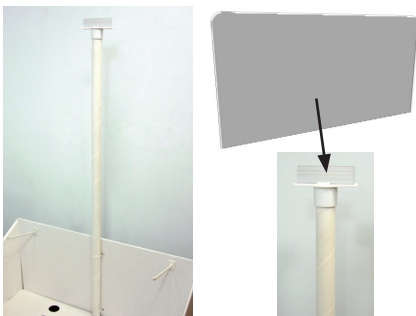

11 Insert peg hooks into peg holes.

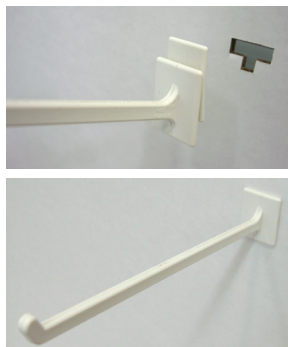

12 Place brochure holder with brochures in base.



Face one row of Reach E-Z's forward and one row of Reach E-Z's backward.

Hang Reach E-Z accessories on peg hooks in base, if desired.